

# IDM - SLH - A60

Heavy Duty External Doors

Sheet 1.1.1.0- Version 02/09/2022

## Performances

- Fire resistance A0/A60 in accordance with IMO Resolution MSC.307(88)  
Fire-post-blast<sup>®</sup> certified.
  - Explosion resistance Up to 110 kPa, 200ms blast isosceles (no destruction of door performance).
  - Gas tightness Standard air leakage rate 0.3 m<sup>3</sup>/m<sup>2</sup>/h @ 50 Pa.
  - Air tightness Class 4 in accordance with EN12207.
  - Wind tightness Class C4 in accordance with EN12210.
  - Water tightness Class 2A in accordance with EN12208.
  - Sound insulation Standard sound insulation value of 36 dB.
  - Thermal insulation U = 0.7 W/m<sup>2</sup>K.
  - Ease of operation Standard opening pressure of 65N.
  - Durability Design lifetime of over 30 years with normal maintenance.
  - Efficiency for maintenance Easy accessibility and spare parts are normally available from stock.
- 
- Optional
    - bullet resistance FB7 non-splinter in accordance with EN 1522/1523.
    - in full compliance with Norsok C-002.
    - sound insulation value up to 48 dB.
  - Aesthetics
    - Thickness: 75 mm.
    - Doors can be supplied in:
      - galvanized steel DX51D + Z275 - standard 2-layer onshore coating.
      - galvanized steel DX51D + Z275 - standard 3-layer offshore coating.
      - stainless steel 316L - micropeen / glassblasting finish.
      - stainless steel 316L - standard 2-layer onshore coating.
      - stainless steel 316L - standard 3-layer offshore coating.
    - Standard RAL end colors included and chosen by client.

## Technical drawing



## Hardware



Stainless steel center latch ID211 / ID221



Doorhandle ID155 / ID156



Stainless steel hinges ID254

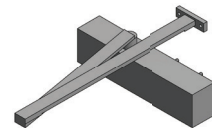

Doorcloser ID261

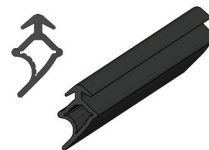

Seal ID164



Panic opening device ID281