

IDM - SLH - A60 - FP

External & Internal Hinged Doors

Sheet 1.1.1.4 - Version 12/08/2022

Performances

- Fire resistance A0/A60 in accordance with IMO Resolution MSC.307(88).
 - Explosion resistance Up to 30 kPa, 200ms blast isosceles (no destruction of door performance).
 - Gas tightness Standard air leakage rate 0.33 m³/m²/h @ 50 Pa.
 - Air tightness Class 4 in accordance with EN12207.
 - Wind tightness Class C2 in accordance with EN12210.
 - Water tightness Class 6A in accordance with EN12208.
 - Sound insulation Standard sound insulation value of 37 dB.
 - Thermal insulation U = 0.7 W/m²K.
 - Ease of operation Standard opening pressure of 65N.
 - Durability Design lifetime of over 30 years with normal maintenance.
 - Efficiency for maintenance Easy accessibility and spare parts are normally available from stock.
-
- Optional - sound insulation value up to 48 dB.
 - Aesthetics Thickness: 73 mm.
Doors can be supplied in:
 - galvanized steel DX51D + Z275 - standard 2-layer onshore coating.
 - galvanized steel DX51D + Z275 - standard 3-layer offshore coating.
 - stainless steel 316L - standard 2-layer onshore coating.
 - stainless steel 316L - standard 3-layer offshore coating.Standard RAL end colors included and chosen by client.

Technical drawing



Hardware



Center latch
ID1120 / ID1130

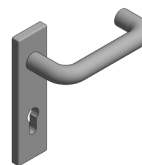

Doorhandle
ID1140



Stainless steel
hinges ID252

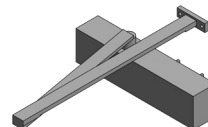

Doorcloser ID260



Seal ID122



Panic opening device
ID281 / ID1171